

# USER MANUAL FOR BLUEMAX USA

## DYNAMOMETERS

### WARNING

All dynamometers are preconfigured for optimal performance and are paired with the supplied display. Changing any of the settings may affect performance.

### SAFETY

Please read all instructions before using the dynamometer to measure loads. Always perform a safety evaluation before use to ensure that the use of the sensor is not dangerous to nearby people or property. The dynamometer is not intended to support personnel working aloft or for overhead lifting. Please follow all standard working-at-height safety procedures. Compliant with ASME B30.26-2015

### CALIFORNIA PROPOSITION 65 WARNING TO CALIFORNIA RESIDENTS

Warning: This product may contain chemicals known to the state of California to cause cancer, birth defects or other reproductive harm

### OVERLOAD

The MWL (MAX WORKING LOAD) of a dynamometer must not be exceeded, as this may cause damage to the internal instrumentation and will invalidate the warranty.

SHOCK LOADING OR OVERLOADING TO MORE THAN 150% OF MWL (MAX WORKING LOAD) WILL RESULT IN PERMANENT DAMAGE TO THE SENSOR. SENSOR SHOULD BE REMOVED FROM SERVICE AND RETURNED TO BLUEMAX USA FOR INSPECTION, REPAIR AND RECALIBRATION

### CALIBRATION

If the dynamometer has been under load for a significant length of time, the sensor may take 1-2 minutes to return to zero when the load is removed. This is to be expected. A significant impact on the body of the sensor can affect the calibration. This would require the device to be returned to Bluemax USA for inspection and re-calibration.

### SWITCHING THE DYNAMOMETER ON/OFF

The Power button has 3 modes: powered on, extended use & off.

Power button	Green ON	Red flash Extended	Red off
Long Press to green flash	Switch on	2000hrs	Refresh rate 1 sec
Long press to red flash	Extended use	8000hrs	Refresh rate 4 sec
10 second press 2 x red flash	Switch off	2 years	N/A

BLUEMAX LOAD SENSING APP

View your sensor, live loads and more on our [iOS APP](#)- point your phone camera at the QR code to download the app.

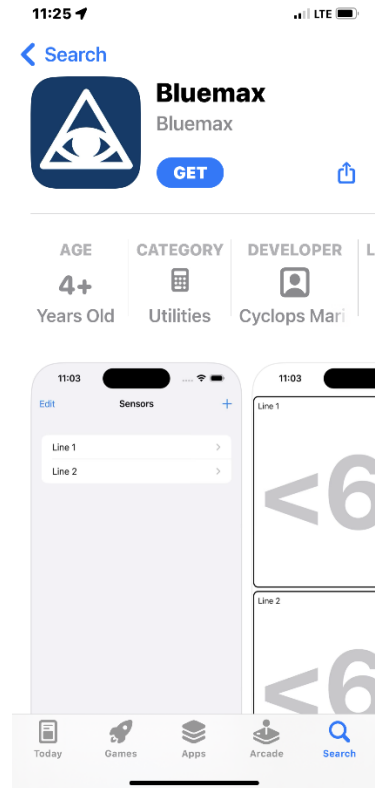

After installation App setup instructions

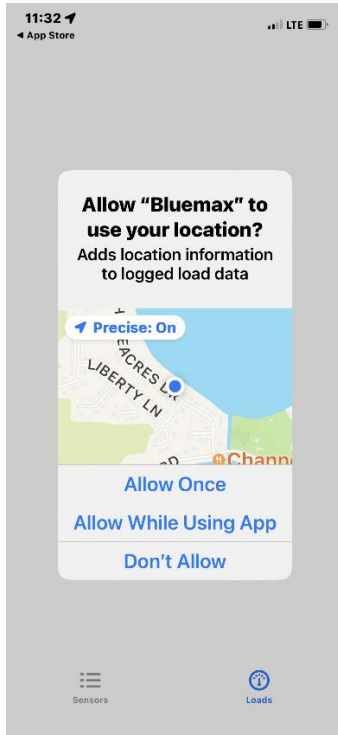

Allow while using the APP

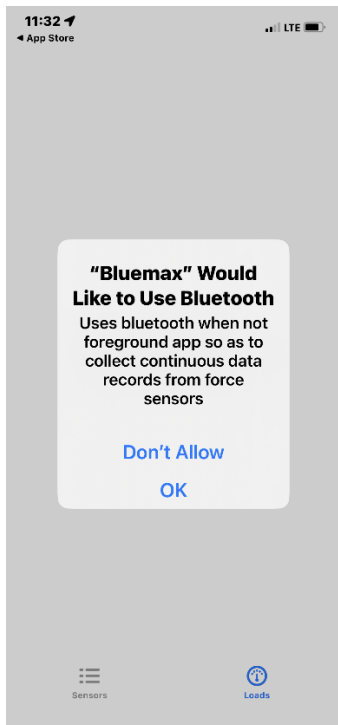

Allow OK (This is how it connects to the dynamometers)

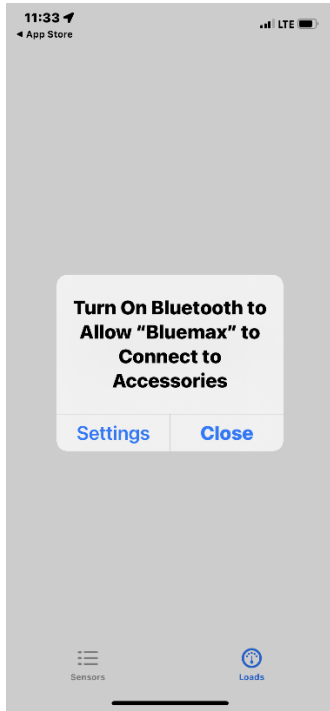

If using air pods or watch please enable

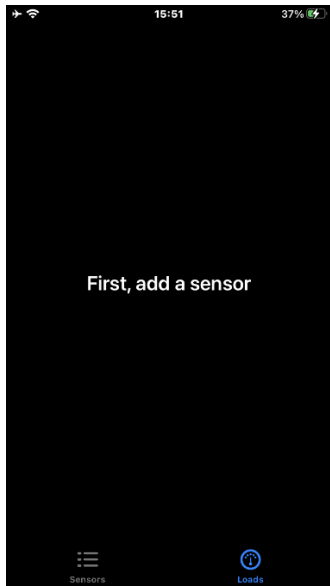

Press sensors to add dynamometers

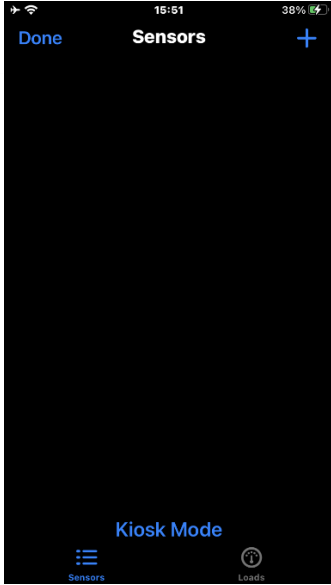

Simply press the + button to add a dynamometer

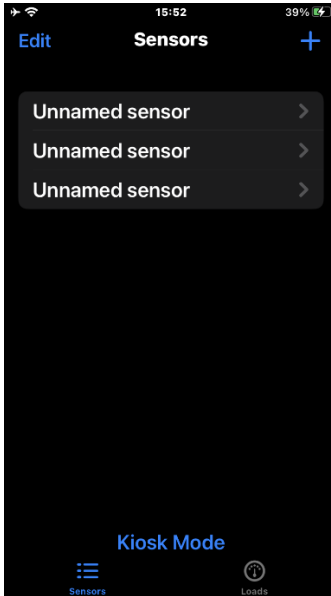

Simply press on the unnamed sensor to setup dynamometer

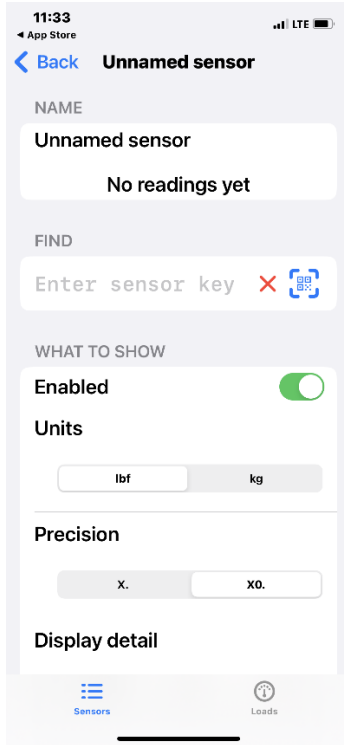

Tap to rename sensor



Scan QR code on case lid to link Dyna



Select load measurement



Select display increments



Select detail of display readout

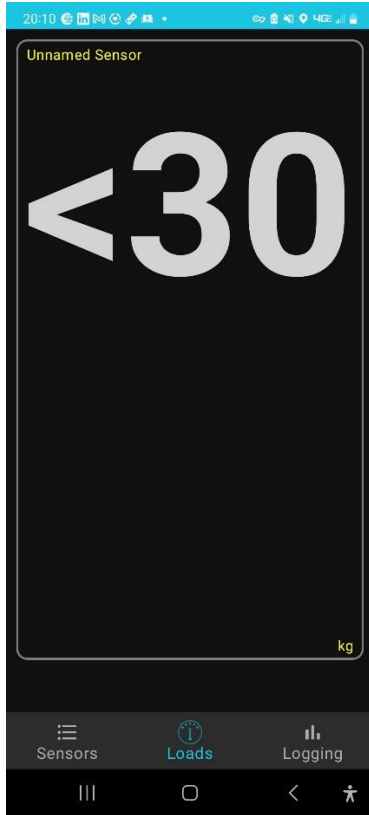

Single sensor view showing dead band limit. Will not display until load exceeds 30 or greater.

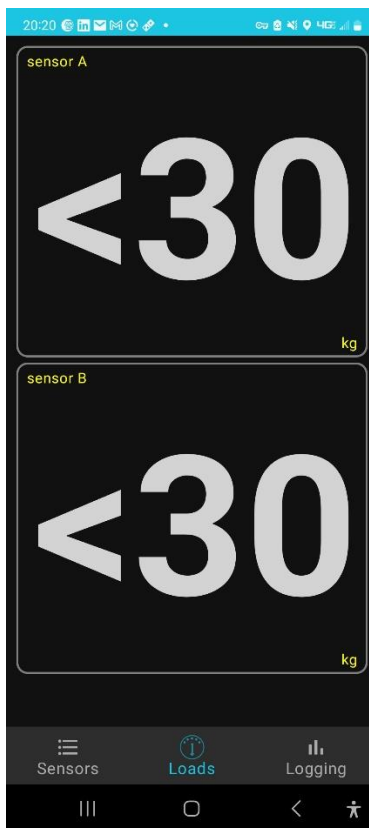

Dual sensor view. Tap each sensor to switch to single-view mode. Tap again to return to dual mode. This will display up to 8 sensors on a single screen.

## WIRELESS CHARGING

To charge the dynamometer, plug the charger into a USB power source (not supplied). The charger will flash Blue when it senses power. Place the dynamometer on the charger with the wireless charging logo facing the rear of the dynamometer (opposite side to the power button). The Dynamometer will flash Red while charging and then switch to Green when fully charged.



## LED LIGHT INDICATIONS

Green	Dynamometer is ON
Green double flash	Battery at 20%
Red flash	Dynamometer in extended mode (reports every 4 seconds)
Solid red	Dynamometer is OFF